

ELKAKON

Proizvodnja industrijskih vodiča
Industrial Wire Production

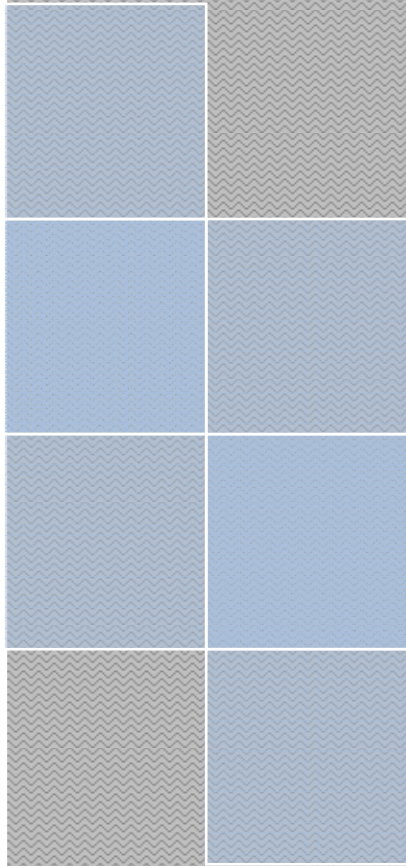

www.elkakon.hr

2012

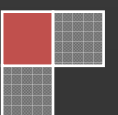

O NAMA

Općenito

Tvrtka Elkakon d.o.o. osnovana je krajem 2003. godine, i njome se nastavlja višegodišnja proizvodnja okruglih i profilnih industrijskih vodiča tvrtki osnivača. Osnovna djelatnost tvrtke je proizvodnja okrugle i profilne žice za transformatore i elektromotore.

Misija i vizija tvrtke

Naš strateški cilj je bio zauzeti vodeće mjesto na hrvatskom tržištu u količini plasirane lak i profilne žice, te proširiti poslovanje na susjedne zemlje i nova tržišta. U tom cilju smo i uspješni zahvaljujući obrazovanim radnicima, te vjernim kupcima.

Vizija Elkakona je ostati tvrtka koja je konkurentna na tržištu, kroz komercijalne uvjete, uz visoku kvalitetu proizvoda, a prema važećim standardima.

U cilju održavanja i stalnog poboljšanja naših visokih standarda kvalitete vlasnici smo certifikata ISO 9001 i ISO 14001.

ABOUT US

Generally

Company Elkakon d.o.o. was established at the end of year 2003., which continues the long production of round and profiled industrial wire form company founders. The main activity is the production of round and profile wire for transformers and electrical motors.

Company Policies

Our strategic goal was to be leader on Croatian market in distributing enamel wire and profile wire and expands business in neighbor countries and new markets. We succeeded thanks to educated workers and loyal customers.

Elkakon vision is to remain competitive company on the market, through commercial conditions and high quality products, defined by known standards.

In order to maintain and continuously improve our high quality standards we are certified to ISO 9001 and ISO 14001.

GOLI VODIČI

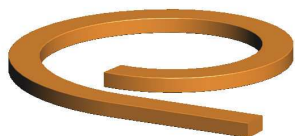

Cu VODIČ		
SIROVINA	Bakar (Cu)	čistoća 99,99%
NORMA	ASTM	B 49
PROIZVODNE DIMENZIJE	Maksimalni odnos $b_1 : s_1$	10 : 1
	Minimalni presjek (mm^2)	10
	Maksimalni presjek (mm^2)	150
PROIZVODNE DIMENZIJE	Okrugla žica	$\geq 0,300\text{mm}$
NORMA	IEC	60317-0-2 60317-0-1
VODLJIVOST	kod 20°C	$\geq 58\text{m}/\Omega\text{mm}^2$
SPECIFIČNI OTPOR	kod 20°C	$\leq 0,017\ \Omega\text{mm}^2/\text{m}$

BARE CONDUCTORS

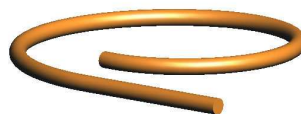

Cu CONDUCTOR		
RAW MATERIAL	Copper (Cu)	Purity 99,99%
NORM		ASTM B 49
PRODUCTION DIMENSIONS	Max. Ratio $b_1 : s_1$	10 : 1
	Min. Cross Section (mm^2)	10
	Max. Cross Section (mm^2)	150
PRODUCTION DIMENSIONS	Round wire	$\geq 0,300\text{mm}$
NORM	IEC	60317-0-2 60317-0-1
CONDUCTIVITY	at 20°C	$\geq 58\text{m}/\Omega\text{mm}^2$
SPECIFIC RESISTANCE	at 20°C	$\leq 0,017\ \Omega\text{mm}^2/\text{m}$

OKRUGLA LAK ŽICA

ROUND ENAMELLED WIRE

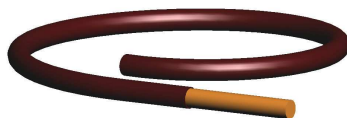

ELMODUR		
SIROVINA	Bakar (Cu)	čistoća 99,99%
PROIZVODNE DIMENZIJE		0,300 – 3,000mm
NORMA	IEC	60317-8
IZOLACIJSKI SASTAV	Osnovni sloj	THEIC modificirani poliestereimid
	Dodatni sloj	-
TEHNIČKI PODACI	Klasa	H
	Prirast	L1, L2
	Temperaturni indeks (°C)	200
	Toplinski šok (°C)	>200
	Temperatura omekšanja (°C)	>340
	Otpornost na otapala	5H
	R22 otpornost	vrlo dobra
	Dielektrična čvrstoća kod sobne temperature	>2 x IEC vrijednosti
	Otpornost na transformatorska ulja	dobra
PRIMJENA	<p>ELMODUR je bakreni vodič lakiran sa THEIC poliestereimidnim smolama uglavnom namijenjen za sve motore, električne strojeve koji rade pri visokim temperaturama (do 200°C). Razvijen je za sve elektrotehničke primjene od malih namotaja preciznih instrumenata do velikih motora i transformatora velike snage i u visokotemperaturnih transformatora. Ima izvrsne mehaničke i toplinske karakteristike, te kemijsku otpornost.</p>	

ELMODUR		
RAW MATERIAL	Copper (Cu)	purity 99,99%
PRODUCTION RANGE		0,300 – 3,000mm
NORM	IEC	60317-8
INSULATION STRUCTURE	Base Coat	THEIC Modified Polyesterimide
	Over Coat	-
TECNICAL VALUES	Class	H
	Grade	G1, G2
	Thermal Index (°C)	200
	Heat Shock (°C)	>200
	Cut Through Temp. (°C)	>340
	Solvent Resistance pencil hardness	5H
	R22 Resistance	very good
	Breakdown Voltage At Room Temperature	>2 x IEC values
	Resistance To Transformer Oil	good
APPLICATIONS	<p>ELMODUR is the copper conductor enamelled with THEIC polyesterimide resins most widely for all motors, electric machines operating at high temperature (up to 200°C). It is deployed for all electro technical applications from the small winding for precision instruments to the large motors and high power alternators and transformers acquiring high operating temperature. It has excellent characteristics of mechanical, thermal and chemical resistance.</p>	

OKRUGLA LAK ŽICA

ROUND ENAMELLED WIRE

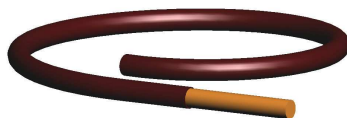

ELMOVER		
SIROVINA	Bakar (Cu)	čistoća 99,99%
PROIZVODNE DIMENZIJE		0,300 – 1,000mm
NORMA	IEC	60317-13
IZOLACIJSKI SASTAV	Osnovni sloj	THEIC modificirani poliesterimid
	Dodatni sloj	Poliamide-imid
TEHNIČKI PODACI	Klasa	C
	Prirast	L1, L2
	Temperaturni indeks (°C)	220
	Toplinski šok (°C)	>240
	Temperatura omekšanja (°C)	>340
	Otpornost na otapala	5H
	R22 otpornost	vrlo dobra
	Dielektrična čvrstoća kod sobne temperature	>2 x IEC vrijednosti
	Otpornost na transformatorska ulja	dobra
PRIMJENA	<p>ELMOVER je bakreni vodič lakiran sa smolama uglavnom namijenjen za sve motore, električne strojeve koji rade pri visokim temperaturama (do 240°C). Razvijen je za sve elektrotehničke primjene od malih namotaja preciznih instrumenata do velikih motora i transformatora velike snage i visokotemperaturnih transformatora. Ima izvrsne mehaničke i toplinske karakteristike, te kemijsku otpornost.</p>	

ELMOVER		
RAW MATERIAL	Copper (Cu)	purity 99,99%
PRODUCTION RANGE		0,300 – 1,000
NORM	IEC	60317-13
INSULATION STRUCTURE	Base Coat	THEIC Modified Polyesterimide
	Over Coat	Polyamide-imide
TECNICAL VALUES	Class	C
	Grade	G1, G2
	Thermal Index (°C)	220
	Heat Shock (°C)	>240
	Cut Through Temp. (°C)	>340
	Solvent Resistance Pencil Hardness	5H
	R22 Resistance	very good
	Breakdown Voltage At Room Temperature	>2 x IEC values
	Resistance To Transformer Oil	good
APPLICATIONS	<p>ELMOVER is the copper conductor enamelled with resins most widely for all motors, electric machines operating at high temperature (up to 240°C). It is deployed for all electro technical applications from the small winding for precision instruments to the large motors and high power alternators and transformers acquiring high operating temperature. It has excellent characteristics of mechanical, thermal and chemical resistance.</p>	

IZOLIRANA ŽICA - PAPIR

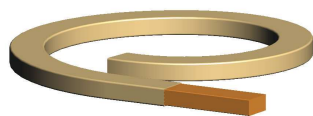

ELKOFIL P		
SIROVINA	Bakar (Cu)	čistoća 99,99%
PROIZVODNE DIMENZIJE	Maksimalni odnos $b_1 : s_1$	10 : 1
	Minimalni presjek (mm ²)	10
	Maksimalni presjek (mm ²)	150
BROJ VODIČA		1
NORMA	IEC	60317-0-2
	IEC	60317-27
IZOLACIJA	Papir (natron, Kraft)	
	Klasa	A
	Temperaturni indeks (°C)	105
	Maks. broj slojeva izolacije	16
PRIMJENA	ELKOFIL P je bakreni vodič izoliran papirom, a namijenjen je za uljne transformatore.	

INSULATED WIRE - PAPER

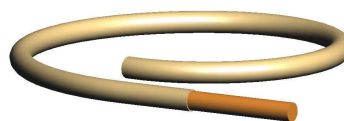

ELKOFIL P		
RAW MATERIAL	Copper (Cu)	Purity 99,99%
PRODUCTION DIMENSIONS	Max. Ratio $b_1 : s_1$	10 : 1
	Min. Cross Section (mm ²)	10
	Max. Cross Section (mm ²)	150
NO OF WIRES		1
NORM	IEC	60317-0-2
	IEC	60317-27
INSULATION	Paper (Natron, Kraft)	
	Class	A
	Thermal Index (°C)	105
	Max. No of Insulation Layer	16
APPLICATIONS	ELKOFIL P is copper conductor insulated with paper intended for oil transformers.	

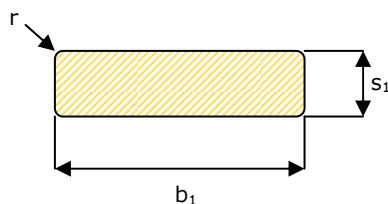

IZOLIRANA ŽICA - NOMEX®

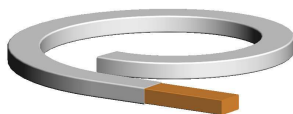

INSULATED WIRE - NOMEX®

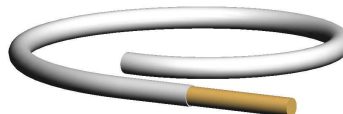

ELKOFIL N		
SIROVINA	Bakar (Cu)	čistoća 99,99%
PROIZVODNE DIMENZIJE	Maksimalni odnos $b_1 : s_1$	10 : 1
	Minimalni presjek (mm ²)	10
	Maksimalni presjek (mm ²)	150
BROJ VODIČA		1
NORMA	IEC	60317-0-2
	IEC	60317-27
IZOLACIJA	Nomex®	410
	Klasa	H
	Temperaturni indeks (°C)	180
	Maks. broj slojeva izolacije	16
PRIMJENA	ELKOFIL N je bakreni vodič izoliran sa Nomex® izolacijom, a namijenjen je za suhe energetske i distributivne transformatore, te za zavojnice.	

ELKOFIL N		
RAW MATERIAL	Copper (Cu)	Purity 99,99%
PRODUCTION DIMENSIONS	Max. Ratio $b_1 : s_1$	10 : 1
	Min. Cross Section (mm ²)	10
	Max. Cross Section (mm ²)	150
NO OF WIRES		1
NORM	IEC	60317-0-2
	IEC	60317-27
INSULATION	Nomex®	410
	Class	H
	Thermal Index (°C)	180
	Max. No of Insulation Layer	16
APPLICATIONS	ELKOFIL N is copper conductor insulated with Nomex® insulation intended for dry power and distributive transformers and for choke coils.	

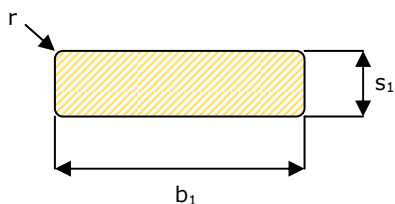

PROFILNA ŽICA – PI TRAKA (KAPTON®)

RECTANGULAR WIRE – PI FILM (KAPTON®)

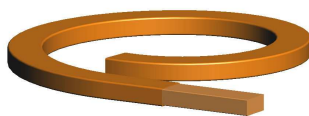

ELKOFIL K		
SIROVINA	Bakar (Cu)	čistoća 99,99%
PROIZVODNE DIMENZIJE	Maksimalni odnos $b_1 : s_1$	10 : 1
	Minimalni presjek (mm ²)	10
	Maksimalni presjek (mm ²)	150
BROJ VODIČA		1
NORMA	IEC	60317-0-2
	IEC	60317-43
IZOLACIJA	Polimidna traka, Kapton®	
	Klasa	C
	Temperaturni indeks (°C)	>250
	Maks. broj slojeva izolacije	2
PRIMJENA	ELKOFIL K je bakreni vodič izoliran polimidnom trakom (Kapton®) sa otpornošću na pojavu „Corona“ struja. Namjenjen je za visokonaponske motore (vučni motori, motori posebnih zahtjeva, motori naftnih pumpi).	

ELKOFIL K		
RAW MATERIAL	Copper (Cu)	Purity 99,99%
PRODUCTION DIMENSIONS	Max. Ratio $b_1 : s_1$	10 : 1
	Min. Cross Section (mm ²)	10
	Max. Cross Section (mm ²)	150
NO OF WIRES		1
NORM	IEC	60317-0-2
	IEC	60317-43
INSULATION	Polyimide Film, Kapton®	
	Class	C
	Thermal Index (°C)	>250
	Max. No of Insulation Layer	2
APPLICATIONS	ELKOFIL K is copper conductor insulated with Polyimide Film (Kapton®). Corona resistance. High voltage motors (traction motors, motors for heavy duty applications, motors for crude oil pumps).	

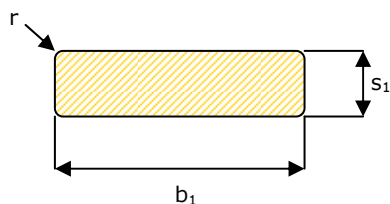

BAKRENO UŽE

COPPER ROPE

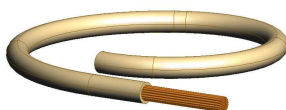

Cu UŽE		
SIROVINA	Bakar (Cu)	čistoća 99,99%
KONSTRUKCIJA	Vidi tabelu	
	Kategorija	5
NORMA	IEC	228
IZOLACIJA	Papir (Kraft), Nomex®	

Cu ROPE		
RAW MATERIAL	Copper (Cu)	Purity 99,99%
CONSTRUCTION	See Table	
	Category	5
NORM	IEC	228
INSULATION	Papir (Kraft), Nomex®	

Poprečni presjek (mm ²)	Konstrukcija	Promjer užeta (mm)	Težina (g/m)
Cross Section (mm ²)	Construction	Diameter (mm)	Weight (g/m)
10	7*11*0,40	4,0	84
16	7*17*0,40	5,0	132
25	7*26*0,40	6,1	201
35	19*14*0,40	7,5	294
50	19*19*0,40	8,9	405
70	19*17*0,50	10,4	579
95	19*23*0,50	12,1	773
120	19*29*0,50	13,6	990
150	37*19*0,50	15,6	1230
185	36*24*0,50	17,3	1530
240	37*30*0,50	19,4	1995
300	60*23*0,50	21,8	2450

USLUGE

U mogućnosti smo obaviti usluge žarenja bakrenih i aluminjskih proizvoda, te oplitanje profilne i okrugle žice, te užadi, sa izolatorima (natron, nomex i dr.)

SERVICES

We are able to give you service of annealing of copper and aluminum products and isolation of profile and round wire and ropes with Kraft paper, Nomex® and PE foils.

PAKIRANJE

Prema standardu IEC 60264-2-1

PACKAGING

Standard IEC 60264-2-1

Oznaka	Unutrašnji promjer (mm)	Širina preko svega (mm)	Širina za namatanje (mm)	Nosivost (kg)	Tara (kg)	Napomena
Type	Inner dimension (mm)	Wideness over all (mm)	Wideness (mm)	Capacity (kg)	Tare (kg)	Comment
K200	34	200	160	~12	~0,6	○
K250	34	200	160	~22	~1,1	○
K355	36	200	160	~50	~1,8	○
A250/400	100	400	335	~50	~1,5	○
A315/500	100	500	425	~100	~2,5	○
S710	51	210	180	~300	~10,8	□

○ - Lak žica (Enamelled Wire)

□ - Profilna žica (Rectangular Wire)

CERTIFIKATI

CERTIFICATES



KONTAKT**ELKAKON d.o.o.**

Proizvodnja industrijskih vodiča

Adresa: Žitnjak bb, P.P. 150, 10001 Zagreb, Hrvatska
 Tel.: +385/1/2452 850
 Fax: +385/1/2452 851
 E-mail: elkakon@elkakon.hr
 Web: <http://www.elkakon.hr>

Posloводство

Direktor: Oskar Pollak, dipl.inž.
 E-mail: oskar.pollak@elkakon.hr

Proizvodnja: Miro Protulipac, dipl.inž.
 E-mail: miro.protulipac@elkakon.hr
 Tel: +385/1/2482 844

Prodaja: Dario Poletti-Kopešić
 E-mail: dario.poletti@elkakon.hr
 Tel: +385/1/2482 645

CONTACT**ELKAKON d.o.o.**

Industrial Wire Production

Address: Žitnjak bb, P.O.Box 150, 10001 Zagreb, Croatia
 Tel.: +385/1/2452 850
 Fax: +385/1/2452 851
 E-mail: elkakon@elkakon.hr
 Web: <http://www.elkakon.hr>

Management

Director: Oskar Pollak, B.Sc.
 e-mail: oskar.pollak@elkakon.hr

Production: Miro Protulipac, B.Sc.
 E-mail: miro.protulipac@elkakon.hr
 Tel: +385/1/2482 844

Sale: Dario Poletti-Kopešić
 E-mail: dario.poletti@elkakon.hr
 Tel: +385/1/2482 645

KAKO DO NAS**HOW TO FIND US**